



Saint Peter Public Schools
100 Lincoln Drive
St. Peter, MN 56082

NON-PROFIT ORG
U.S. POSTAGE
PAID
PERMIT #10
ST. PETER, MN 56082



RESIDENTIAL CUSTOMER

Learn more at MendTheMiddle.org

EARLY VOTING NOW OPEN! VOTE ON OR BEFORE TUESDAY, APRIL 9.

MendTheMiddle.org [@saints508](https://www.facebook.com/saints508) [@saints508](https://www.instagram.com/saints508) [@Saints508](https://twitter.com/Saints508) 507.934.5703

Prepared and paid for by Independent School District No. 508 (Saint Peter Public Schools), 100 Lincoln Drive, St. Peter, MN 56082.
This publication is not circulated on behalf of any candidates or ballot questions.

A MESSAGE FROM SUPERINTENDENT GRONSETH



To our Saint Peter community:

Saint Peter Public Schools is an exciting place to learn and grow, and I am proud to call it home. Our goal is to provide a quality education that prepares all students for successful lives as global citizens in the home, community, and world.

Starting in 2022, our district completed assessments of the quality of our middle school building. Using the results of these assessments, our district worked with construction and financial experts to develop a fiscally responsible investment plan to address the most critical needs of the building. In addition, we gathered feedback from our staff and community. Our school board and administration are confident the proposed plan best reflects our most critical facility needs. If approved, the building bond referendum will primarily impact our middle school environments — spaces that have served us well for decades but require critical updates to best support our Saints in grades 6-8.

We encourage our community to be informed about the proposed plan and how it addresses key challenges facing our middle school. **Please visit MendTheMiddle.org to learn more about the plan and don't forget to vote on or before Tuesday, April 9.**

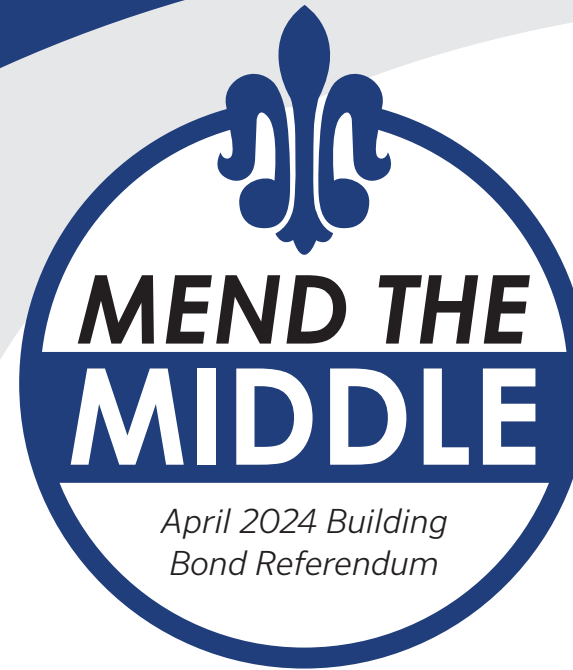

Learn more at MendTheMiddle.org

MEND THE MIDDLE:

A Plan to Invest in Saint Peter Middle School

To ensure that Saint Peter Middle School can continue to support the next generation of students, Saint Peter Public Schools is asking residents to consider a \$10.965 million investment plan to improve the health, accessibility, and educational adequacy of the building. District residents will have the opportunity to vote on the plan during a building bond referendum on Tuesday, April 9.

Early voting is now open! Visit MendTheMiddle.org/vote for details.



WHAT CHALLENGES IS THE MIDDLE SCHOOL FACING?

The middle school building was built in 1958 as the district's high school. While the building has served the district well for decades, today, the building faces challenges related to its age and outdated design.

Students and staff are impacted by several issues, including:

- Leaky windows and frames
- Fixed workstations in science classrooms that don't support interactive learning
- Only one or two electrical outlets in most classrooms
- Original bathrooms that are not ADA-compliant
- Worn-out interior finishes in classrooms, hallways, and lobby spaces
- To avoid disrupting PreK classes on the second floor, students are not able to use the stairwell in the 1964 wing of the building, which bottlenecks and diverts student traffic



DID YOU KNOW?
Our middle school was originally built and used as a high school.



THE PLAN TO IMPROVE SAINT PETER MIDDLE SCHOOL

After over a year of research and planning, the district has developed a plan to invest \$10.965 million to improve the health, safety, and educational adequacy of the middle school. Residents will vote on the plan during the referendum on April 9. If approved, the plan will:

- Renovate science and art classrooms to better support modern curriculum and interactive learning
- Renovate 2nd and 3rd floor restrooms to be ADA-compliant and add single-user restrooms on each floor
- Repair leaky windows and frames
- Replace the stairwell in the 1964 wing with an external stairwell to improve student circulation
- Replace paint, finishes, and flooring in select classrooms, hallways, and lobby areas
- Add additional electrical outlets to most classrooms
- Add acoustical treatments to gymnasium B to reduce noise and echoing

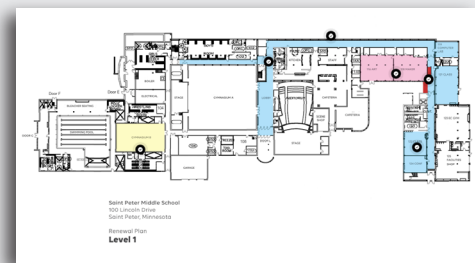

Learn more: MendTheMiddle.org/plan

Boiler and HVAC Replacement

In December 2023, the school board used its existing bonding authority to replace the building's failing boiler and HVAC system. The boiler and HVAC replacement is **separate** from the bond referendum, but if the referendum is approved by voters, the improvements will be completed at the same time to save time and expense.

THE TAX IMPACT

If approved by voters, the \$10.965 million investment will be supported by a property tax increase starting in 2025, which would expire after 20 years. Your tax impact would depend on the value of the property you own.



\$225,000 residential home =
\$5.50
per month starting in 2025



USE OUR TAX CALCULATOR AND DETERMINE YOUR ESTIMATED TAX IMPACT!

Learn more: MendTheMiddle.org/cost



THERE ARE THREE WAYS TO VOTE

VOTE EARLY FROM HOME





Starting on Friday, February 23, district residents can vote early from home via absentee ballot. Learn how to apply for a ballot at MendTheMiddle.org/vote.

VOTE EARLY IN PERSON

Starting Friday, February 23, early voting will be available in person at the Nicollet County auditor's office on weekdays between 8:00 a.m. and 4:30 p.m.

VOTE IN PERSON ON ELECTION DAY, APRIL 9

Polls will be open on Tuesday, April 9, from 8:00 a.m. to 8:00 p.m. at the following locations:

-  National Guard Armory: Residents located in the City of Saint Peter Ward 1 - Precinct 1.
-  Saint Peter Community Center, Door B: Residents located in the City of Saint Peter Ward 2 - Precinct 1.
-  Johnson Hall: Residents located outside the City of Saint Peter in Nicollet County.
-  Kasota Community Center: Residents located outside the City of Saint Peter in Le Sueur County.

Please note: District residents can **not** vote on the referendum during the presidential primary on March 4 or on a primary absentee ballot. State law requires separate ballots for each.

For full voting details, visit MendTheMiddle.org/vote

